

RESTRICT FLOW

Anti-Cavitate Orifice Plate™ Specification Sheet

RestrictFlow.com

Restriction Orifice Model: RO-200 Series

***Each Anti-Cavitate flow element is specifically designed per flow condition:**

1. Design Data for Anti Cavitate Flow Restrictor Design
 - a. Fluid: Water
 - b. Flow Rate - GPM 3590
 - c. Pressure in: 112 psig
 - d. Pressure out: 2.1 PSIG
 - e. Temperature of Fluid: 60F
 - f. Pipe: 12"nom, sched 12.39 ID"
 - g. Flange rating: 125# (AWWA C115)
 - h. Material: 316 SS

The Anti-Cavitate Flow Element with conditions above will fit **within the following envelope:**

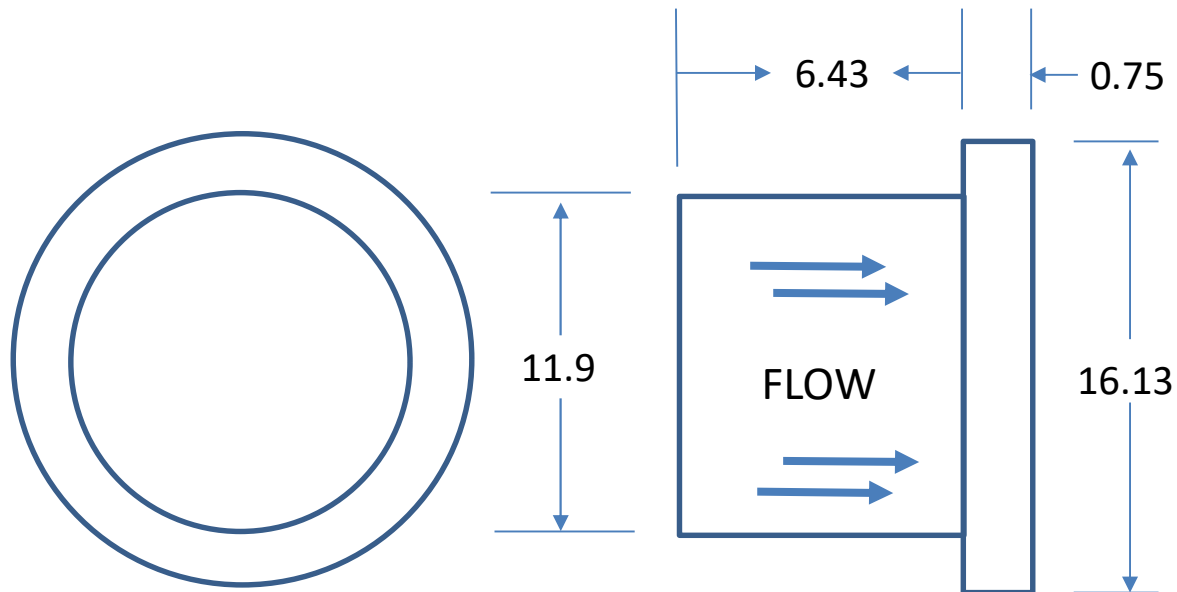

*Actual Element is not displayed

The above item will be placed between two Flanges with gaskets (not provided). The flanges will have to be separated approximately 8 inches in order to be installed, otherwise a pipe spool may be used to facilitate installation by holding the flow element in place and then sliding the pipe spool in for fit up.



Anti Cavitate Orifice Plate 12”

Page 2 of 2
12”V1, 04/01/26

- Single Stage, 3 dimensional design for each flow condition
 - Alters fluid flow to eliminate the destructive effects of cavitation.

 - Markings and ID added to a welded handle per customer requirements.

***NO MORE MULTI-STAGE**

Our proprietary anti-cavitate orifice plate removes the need for multi-stage orifice plates. Multi-stage plates are often needed because the pressure reduction ratio is too high for a single orifice plate. One of our orifice plates has the ability to achieve the desired pressure drop while eliminating the need for multiple plates.

***ELIMINATE CAVITATION DAMAGE**

Cavitation causes significant damage to equipment, increasing the need for replacements and maintenance. Erosion and corrosion can cause plates to lose strength and ability to perform in a consistent manner. Our anti-cavitate orifice plate restricts flow while combating cavitation, decreasing the need for future replacements of the plates and the equipment.